

Plot Date : Tuesday, August 11, 2020 9:28:48 am

AutoCAD File Name : /Users/michael/Dropbox/project work/Elsa/269C MGRA 011 Final with tracking.dwg

Proposed Access and Movement Strategy - Expanded Site

- ① All Elsa traffic to enter site via Durham Street (HGVs and staff/visitor cars)
- ② Vehicles pass through sliding security gate to access site
- ③ All traffic will route to east of Climax Works building to access either staff/visitor parking or weighbridge
- ④ Inbound HGVs to be weighed on weighbridge
- ⑤ Dedicated HGV layover space on site, to ensure no Elsa vehicles wait on Station Road or other sections of the public highway
- ⑥ All vehicular traffic to route in anti-clockwise direction around Climax Works building
- ⑦ Vehicular traffic routes either to rear of storage area (northern boundary of site) or southwards to unload plastic and paper into existing Elsa building
- ⑧ Secondary unloading area for plastic and paper recycling
- ⑨ Main unloading area for plastic and paper recycling
- ⑩ Once unloaded HGVs will move away from unloading areas and route anti-clockwise around Climax Works building to either layover on site or route to northern loading area or western container loading areas
- ⑪ All HGV traffic to route into existing concrete yard from loading/unloading area
- ⑫ Container HGVs to be loaded in western concrete yard
- ⑬ If required, all HGVs to have access to existing weighbridge before exiting site
- ⑭ All HGV traffic to undertake left turn out manoeuvre through existing gated access
- ⑮ No HGV waiting on Station Road and no requirement for staff/visitor car parking in echelon parking bays

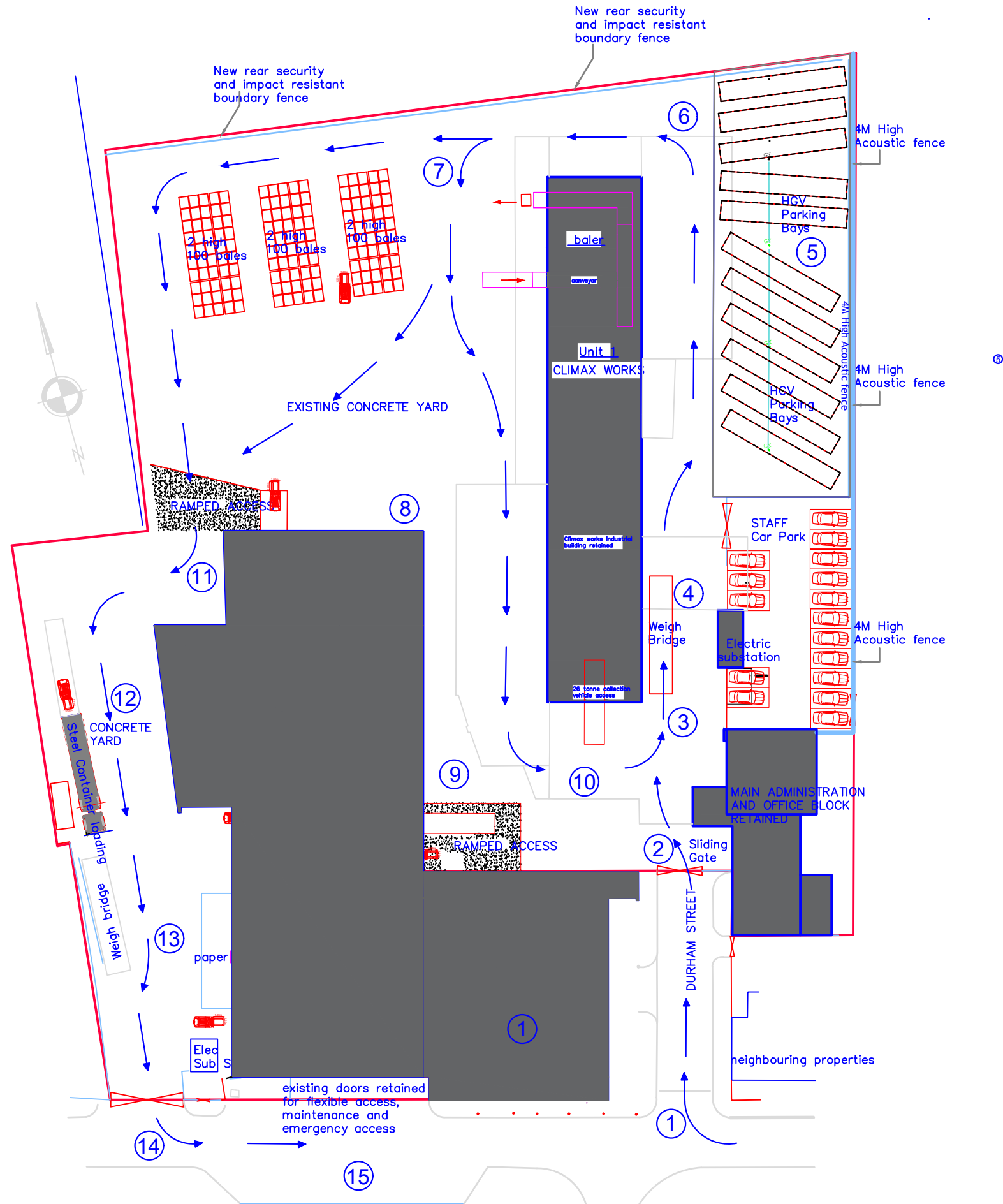

THIS DRAWING MAY BE USED ONLY FOR THE PURPOSE INTENDED AND ONLY WRITTEN DIMENSIONS SHALL BE USED

NOTES

Revision Details	By	Date	Suffix
	Check		

Drawing Number	SK21903-30 REV B
----------------	------------------

Elsa Recycling Plant
Drawing Title
Proposed Access, Movement and Operation Strategy Wider Site

Scale at A3	NTS
-------------	-----

Drawn	KAT	Approved	MAK
Check	KAT	Date	11/08/20

SK Transport Planning Ltd
 Albion Wharf, 19 Albion Street
 Manchester M1 5LN
 Telephone (0161) 234 6509
 Fax (0161) 236 7959

